

House & Land

Morrinsville



📍 LOCKERBIE ESTATE,
MORRINSVILLE

FROM \$890,000

Are you looking for a vibrant community in an ideal location to embrace an active lifestyle and raise your family? Come home to Morrinsville!

 **Platinum
Homes**
Everything You Call Home

Floorplan Tokoroa

An easy 30-minute drive from downtown Hamilton, Lockerbie Estate Morrinsville lies in the centre of the "Golden Triangle". Perfect for people who want to stay connected to Hamilton, Bay of Plenty & the Coromandel but live in a central small town where the sense of community is strong.

The Tokoroa plan works beautifully on this available lot. This 170sqm urban style design has everything you could want in a modern family home. The floor plan features an open plan kitchen which connects to the dining and living areas which is great for family living and entertaining.

As with all the plans in the Platinum design suite, the specifications can be tailored to individual needs and altered to meet the vision you have in mind of your perfect dream home. Talk to our knowledgeable team about building a plan to suit your lifestyle on this section.

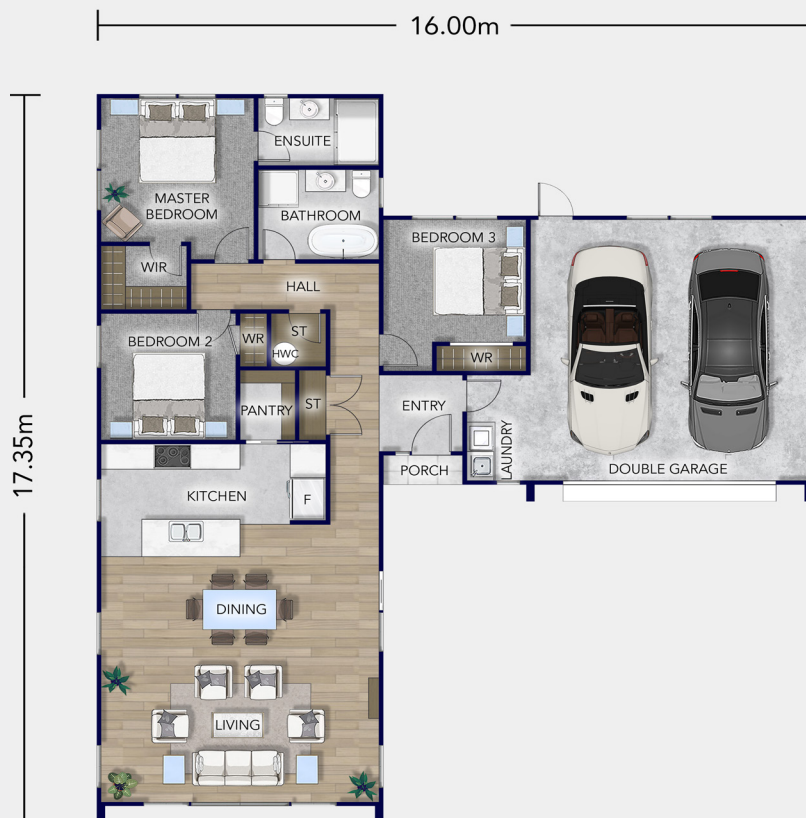

Total Floor (m2) 170



1



3



2



2



2

Love this home? Get in touch

Brad Wheeler

Licensee

027 687 8171

brad.wheeler@platinumhomes.co.nz

Angela Wheeler

Licensee

027 687 8177

angela.wheeler@platinumhomes.co.nz

**Platinum
Homes**

Dimensions, images and floorplan are indicative only — not to scale.

Floorplan ©2021 Platinum Homes NZ Ltd — not to be reproduced without permission of the copyright holder.